

GRABER POST BUILDING'S STANDARD POST FRAME DESIGN

This design is used for most detached garage applications, including but not limited to Agricultural barns, Hobby sheds, General storage, Gardening sheds, and many more.

We will dig the post holes according to your plan. Our poles are spaced at 8' apart on each wall.

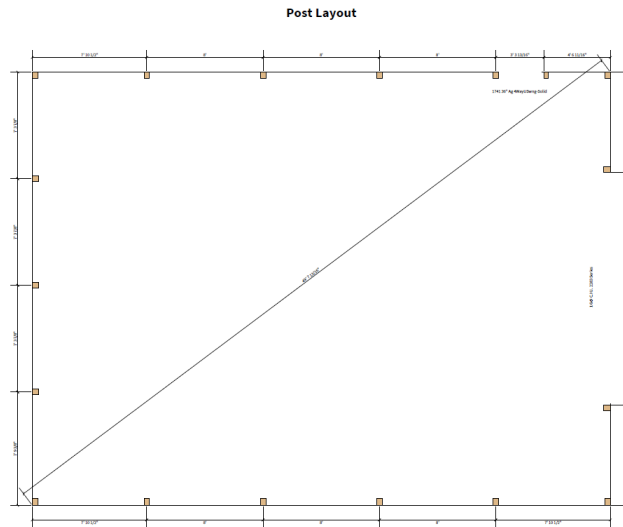

A 15" Precast Concrete Cookie is then placed at the bottom of each hole. Then each laminated 3 ply post is inserted into the holes, measured and leveled up, then backfilled with an 80# bag of pre-mixed concrete.

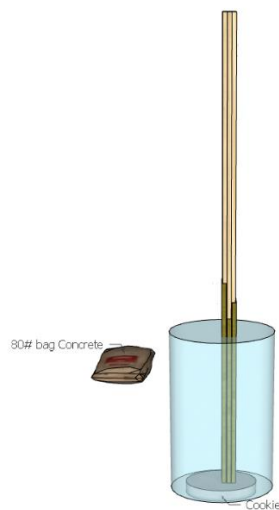

The wall framing is then attached to the posts. As you can see on the design below, we have 2 rows of treated skirtboards that may also serve as the form for a concrete floor that is optional. We have 2x4 spruce wall girts spaced at 2' apart, on each wall, with a larger framing material at the top to support the trusses and your roof structure. These truss supports will also be placed inside the wall and sized accordingly.

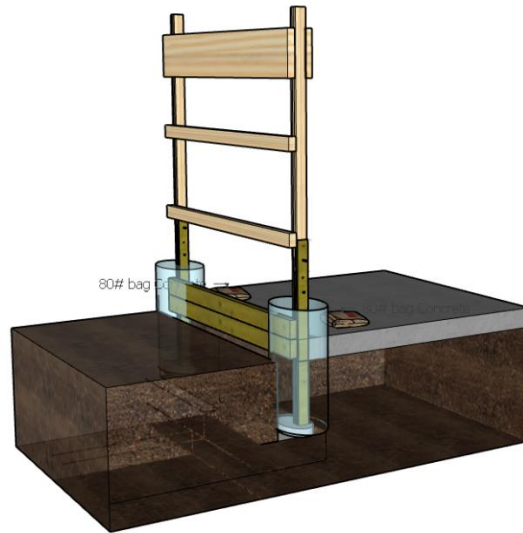

After the walls are all framed, we are ready to set the trusses for your roof system.

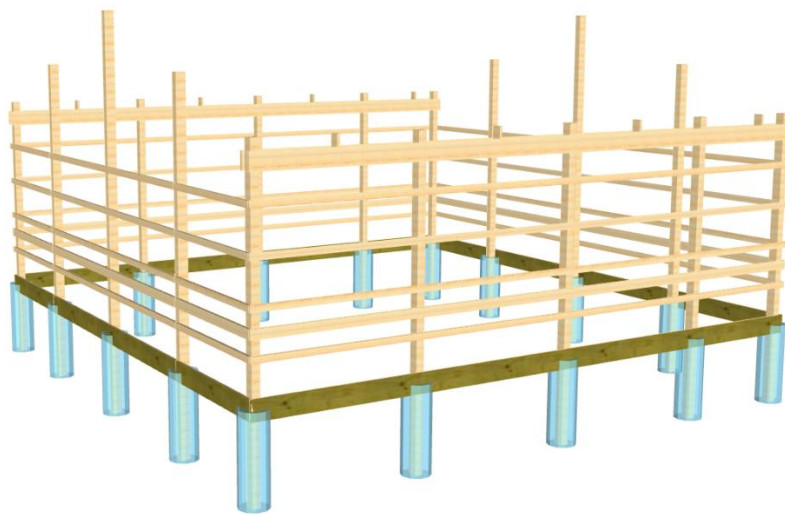

The trusses are fastened to the top of the wall spaced at 4' apart. We install bracing in the trusses as needed per your design. We install 2x4 roof purlins onto the top of the trusses at 2' apart. There is also a purlin placed a few inches from the peak to fasten the ridge cap trim later on.

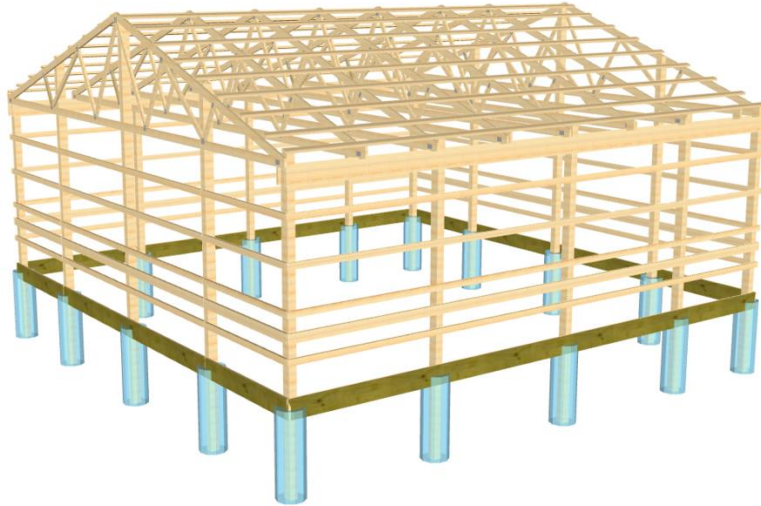

We use our 40 Year G-Rib profile 29 Gauge metal on the roof installed on top of a rolled vapor barrier material. This can be upgraded to an EPS foam board insulation up to 1" thick

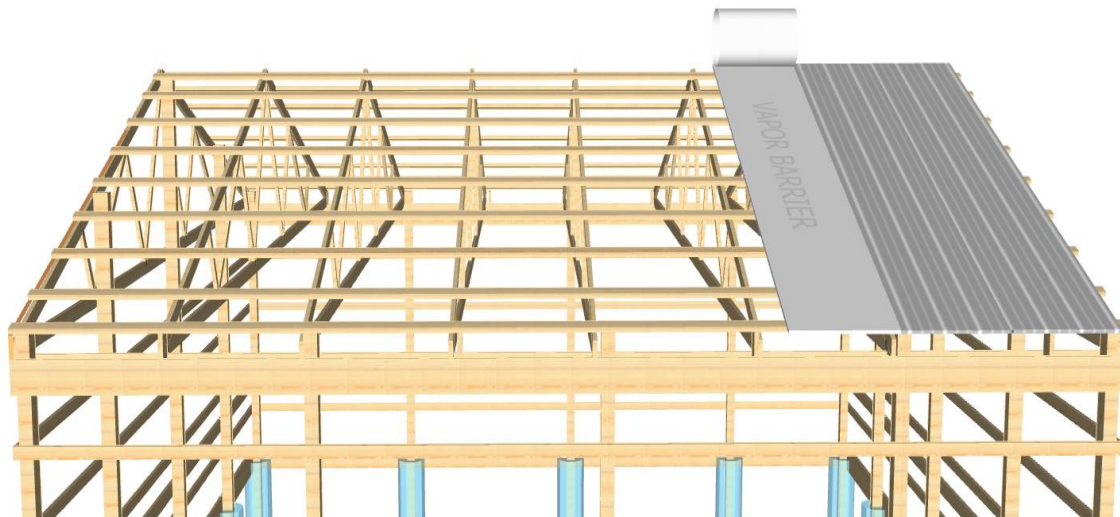

After the roof is completed, the same would apply to the sides. The metal will be installed and may include a vapor barrier or insulation board, same as the roof. If you plan to finish the interior at any time, a house wrap is recommended to prevent condensation. Or if this is just a garage you plan to heat occasionally, either a $\frac{1}{2}$ ", $\frac{3}{4}$ ", or even 1" EPS foam can be used.

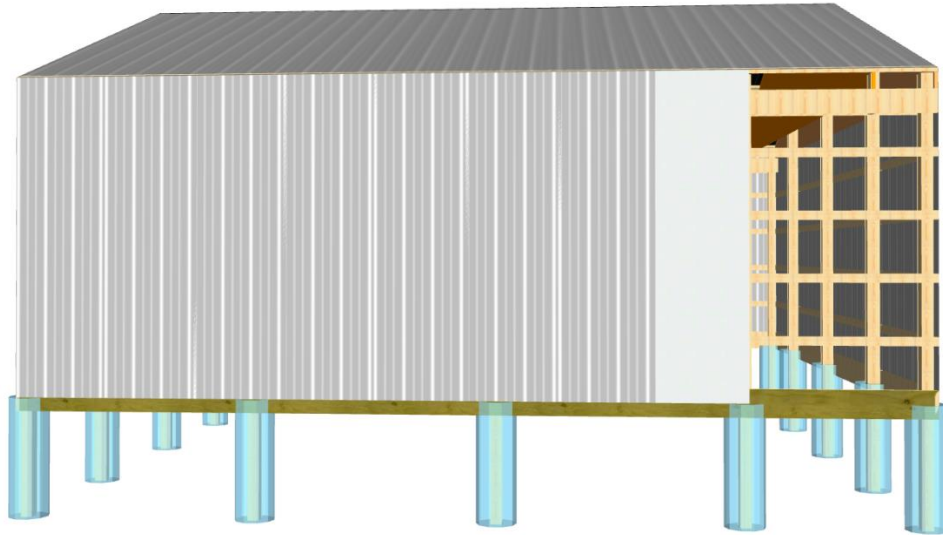

Our next step is installing all necessary trims for a finishing touch to your project.

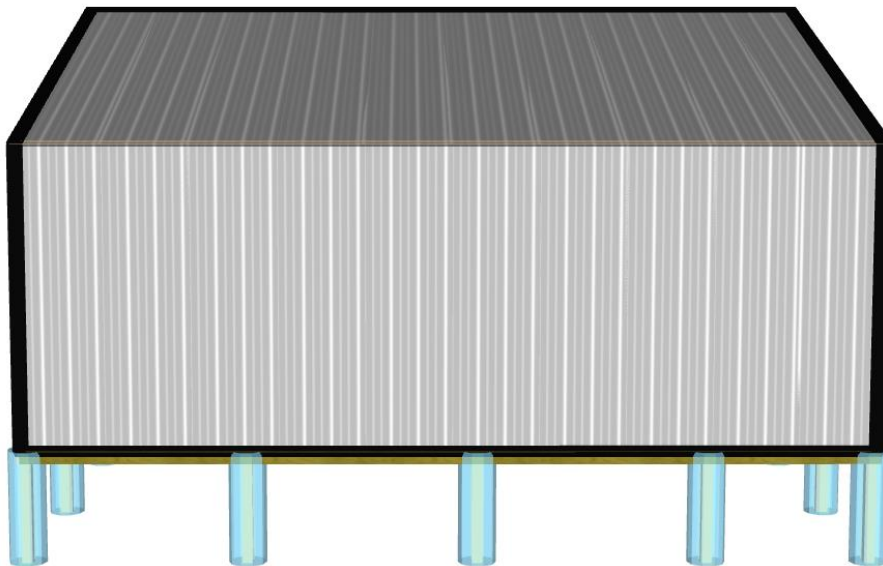

GRABER POST BUILDING'S

Foundation Upgrades

Our post frame design can be upgraded in several different ways. This may be just a choice you make or it might even be a requirement for your local building codes. Some counties require a foundation upgrade for structures that will be used for residential living areas or commercial applications.

The first option would be grade guards which can prevent post decay right at the ground level. It consists of a plastic sleeve placed on each post.

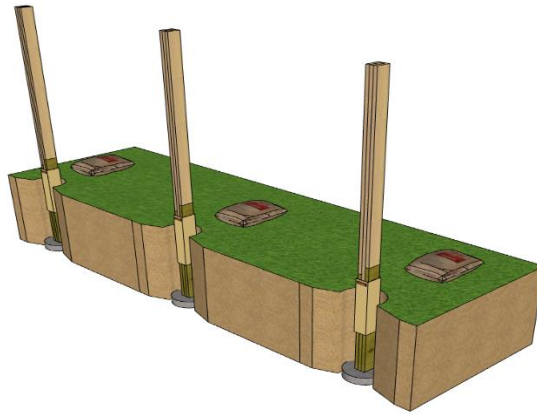

The next option is an extended version of the first, but this includes a full sleeve to prevent the post from being in contact with the soil.

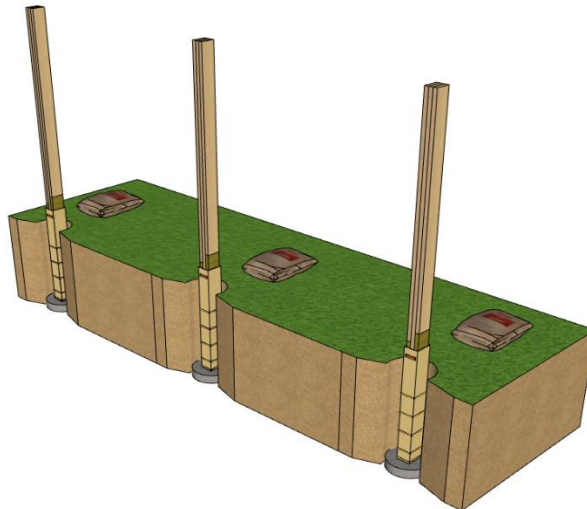

Next, we have a more permanent option with the Perma-Column. It consists of a 60" section at the bottom of the post that is solid concrete.

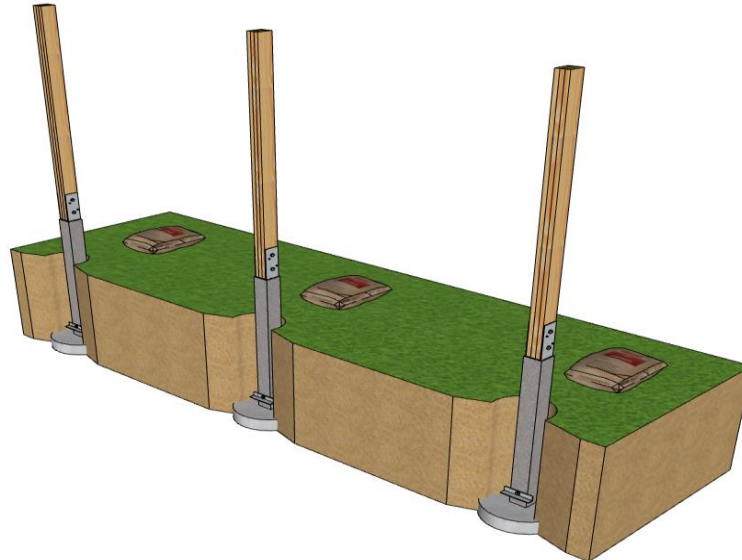

If you desire, we can even build this same type of structure with a continuous footing. This is usually the case if you plan to use the structure as a house or commercially. Another reason you may need to go with this design would be for elevation differences. The building site you have may be several feet off-level so we will pour a continuous wall to support the posts, using a steel bracket. We normally use the wet-set option unless the foundation is existing or poured by others, then we opt for the drill-set design.

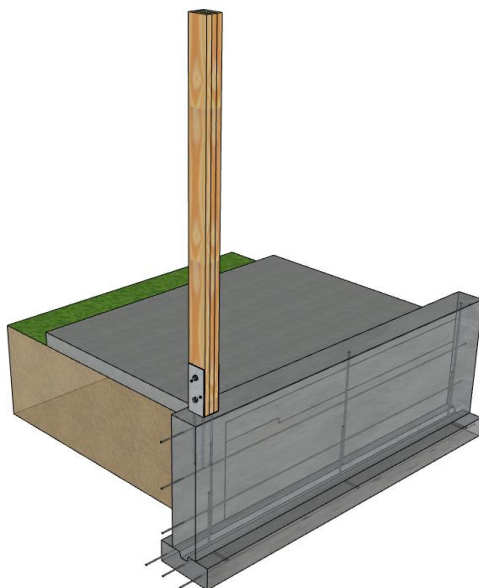

Sturdi-Wall Wet-Set Brackets

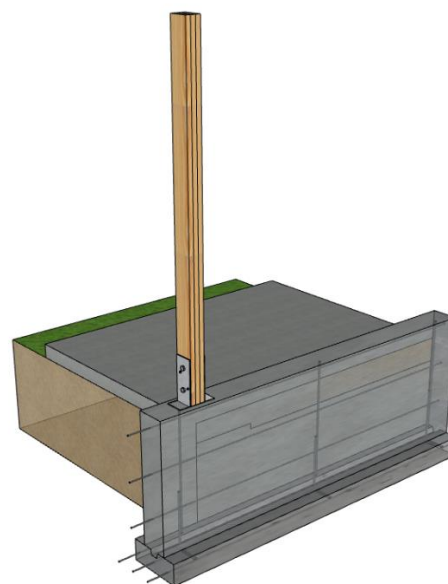

Sturdi-Wall Drill-Set Brackets

GRABER POST BUILDING'S Windows

We offer several different window styles provided by  windows.

Many of our pole barns include our vinyl horizontal slider or may even be upgraded to include grids as shown below. We stock several sizes of this style without grids.

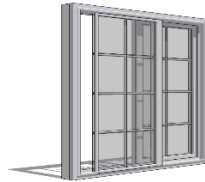

You may decide to go with a more residential style window and choose a double hung window. Again these may be with or without grids. We stock several of these models.

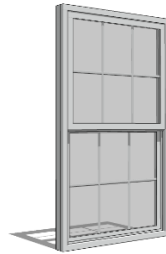

Casement windows that can be opened similar to a door. Awning style windows, which are similar to a casement, but are set horizontally. Fixed windows may be used in some applications such as bathrooms above a shower, or office areas.



Casement

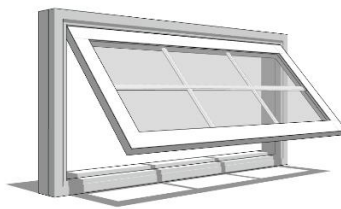

Awning

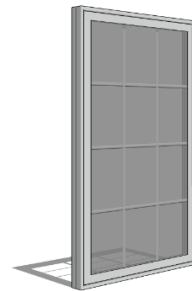

Fixed

GRABER POST BUILDING'S

Entry Doors

Many of our pole barns include Entry Doors from



We stock several 1700 and 1900 series models primarily in 36" width. The flush white models are available as a 48" width and even a 72" double door that are usually in stock also.

1700-SERIES ENTRY DOORS - Model 1741

A general utility door for agricultural buildings, our 1700-Series doors have the features you need. With a panel that is 1-3/4" thick, you can easily use standard door accessories. These pre-painted, pre-hung doors feature universal swing, rolled-edges, steel skin and a polyurethane core - it makes for a sturdy durable choice.

Or if you are looking for a little better option, we will use the

1900-SERIES ENTRY DOORS - Model 1920

The 1900-Series doors cover all bets for agriculture, commercial and metal building projects. Its 24-gauge skin and 16-gauge steel jamb offer durable security -- while the wide variety of panel embossment options provide appealing matches to interior door choices.

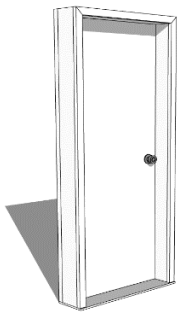

Flush White Model

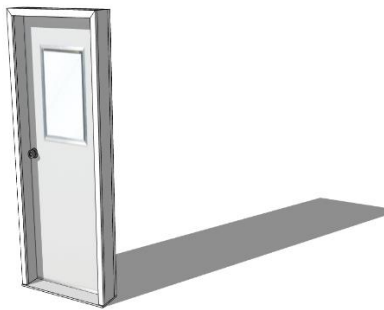

20x24" glass window



9 Lite Glass model

Or for Commercial applications . .

2008-SERIES ENTRY DOORS

Known for robustness and security, the 2008-Series doors are great choices for high traffic entrances on building code projects. Durable features include 20-gauge steel skin panels (18-gauge option) matched with a robust 7-gauge hinge reinforcement and 14-gauge reinforced panic, closer and deadbolt prep.

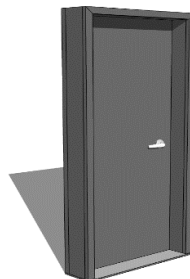

We also offer Entry Doors from



There several different fiberglass models in stock in white. If you need a custom color, that is not a problem, we can have the door pre-finished locally with a premier paint.



6 Panel Primed White



9 Lite Fiberglass

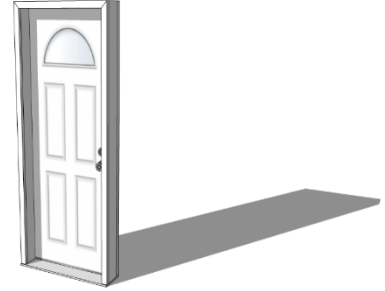

Custom styles to order

If you need an Entry Door for your barn or maybe just like the rustic look on your garage, you might choose one of our doors from



The Silvercraft XL Dutch Doors are constructed with a 2"x3" .125 aluminum tube frame door, and all welded corners. The complete frame is sanded and powder coated, leaving a flat seamless finish. The door jamb is .125 aluminum with a weld-on 6" aluminum bullet hinges with ½" stainless steel pin. A bumper seal on the jamb provides a tighter seal and quiet operation. A 3" barrel bolt allows the door to operate separate, or as one. A heavy door latch and all necessary mounting hardware is included. Upgrades on this model can include Arch Top, Double Buckboard, Glass Top with Grids, and Custom Sizes.

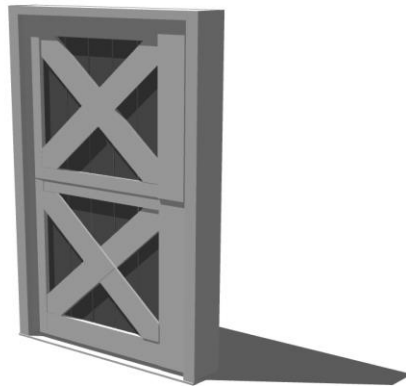

GRABER POST BUILDING'S Overhead Doors

We offer several different overhead models provided by **C.H.I. OVERHEAD DOORS**

Here at Graber Post Buildings, we stock several sizes of the 2283 series model and a cheaper 2250 economy model that is non-insulated in white. Any other model that they design, we can order and have within a few weeks. If you'd like we can install an automatic opener also.

2283-SERIES OR 2250-SERIES OVERHEAD DOORS - (WINDOWS OPTIONAL)

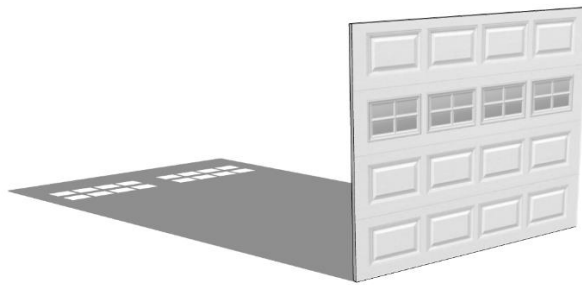

Here are a few other popular styles they offer.



5283 Series Carriage House



5283 Series Carriage House in Driftwood

Or the all new Skyline Flush series. . .

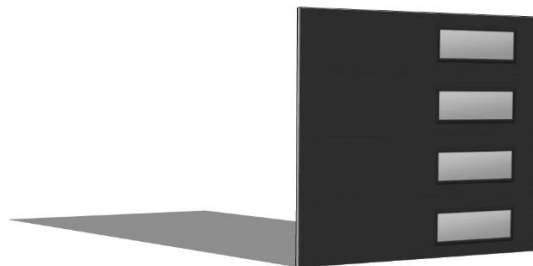

Skyline Flush in Black

GRABER POST BUILDING'S Sliding Doors

There are several options available in our sliding barn doors. We can design a single panel sliding for your most economical door. Usually we see these in horse barns or non-insulated storage sheds. These doors can be upgraded to a split design that slides $\frac{1}{2}$ of the door each way from the opening.

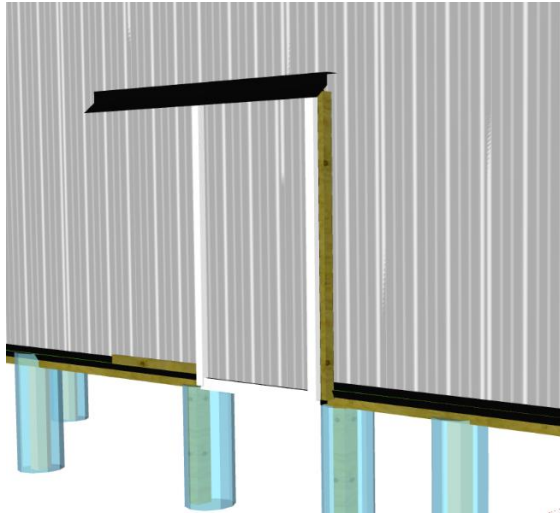

Single Slider

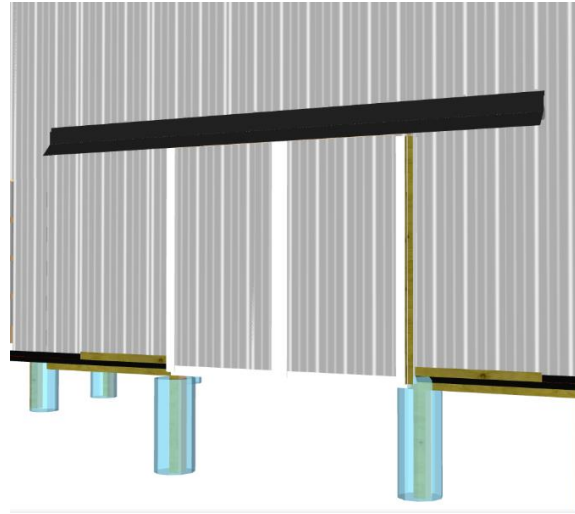

Split Slider

We can also customize your door to include windows or crossbucks. These are constructed onsite from custom GPB materials and trims. If you are looking for a premium model of sliding doors, we recommend our door line from



Silvercraft doors can be upgraded to include an arched glass window or even brush seals for a more secure door. These models will come pre-assembled.

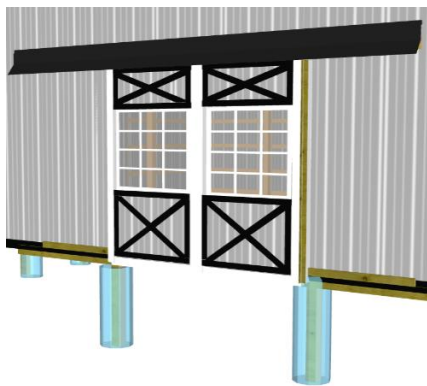

Custom GPB Door

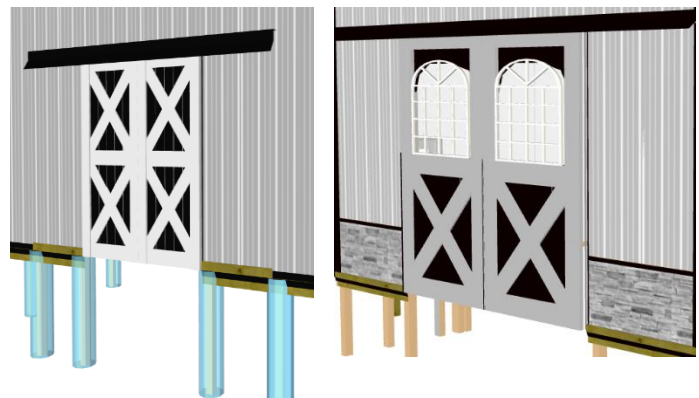

Silvercraft Doors

GRABER POST BUILDING'S Building Upgrades

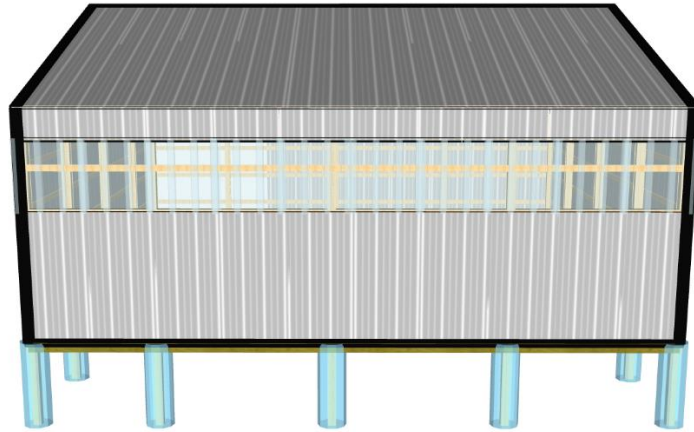

Eave Lights

We can install a clear section of wall sheathing to provide a cheap source of lighting in you barn. These Polycarbonate panels will match the profile of the rest of the siding. Normally this would be used in buildings that would not be heated or conditioned.

Sky Light Ridge Cap

Ridge Cap can also be upgraded to a clear material for a great light source.

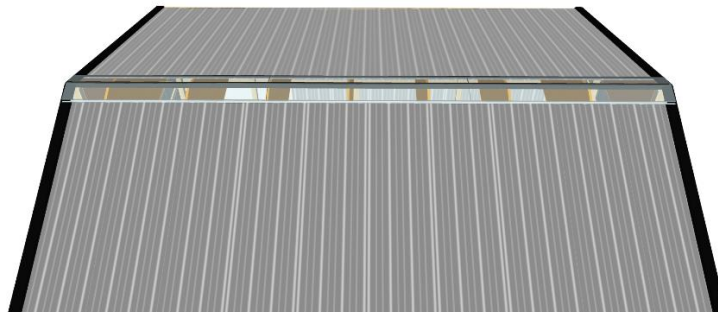

Guttering and Downspouts

We have 5" or 6" K-Style steel guttering any color to match our trims. If we are constructing the project for you, we will even roll the guttering out onsite for a seamless product.

We will recommend a snow guard trim, as shown to protect your gutter from ice and snow.

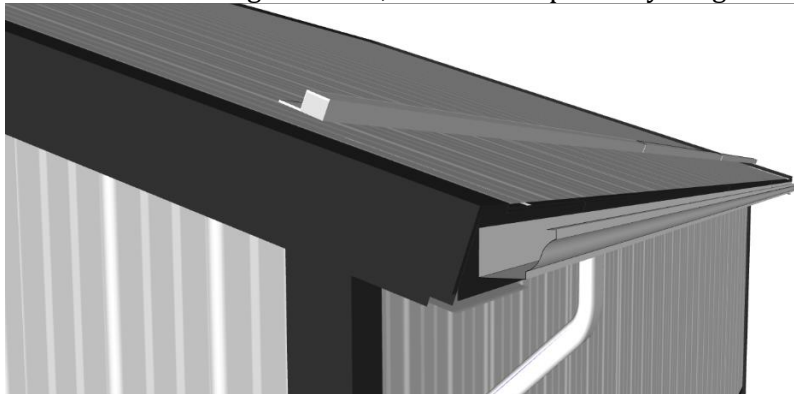

GRABER POST BUILDING'S Building Upgrades

We offer cupolas kits from



Our most popular would be the model with the louvered sides. These cupolas can be vented if you would like but usually are only used for aesthetic purposes. The windows on the sides are also available as an upgrade. Sizes available include: 24" x 24", 36" x 36", 48" x 48", 66" x 66". Our kits include a weathervane as standard.



24"

Stock Weathervanes
30"



Country Doctor



Eagle



Horse



Rooster



Antique Auto



Country Doctor



Duck



Horse



Pig



Rooster



Tractor



Sailboat



Buck



Cow



Eagle



Pheasant

46"



Eagle



Horse



Rooster



Sailboat

30" Non-Stock Weathervanes

Please note, Non-Stock Weathervanes will only be offered in a black finish as of April 30, 2020.



Airplane



Antique Auto



Bear



Blue Heron



Buck



Cardinal



Cat



Country Doctor



Cow



Deer in Pines



Duck



Eagle



Elk



Fire Wagon



German Shepherd



Golden Retriever



Golfer



Horse



Hummingbird



Lab



Liberty Flag



Lighthouse



Loon



Mare & Colt



Moose



Motorcycle



Pheasant



Pig



Rooster



Sailboat



Schooner



Spear



Tractor



Train



Trout

GRABER POST BUILDING'S

Roof Upgrades

When it comes to roof styles, we start with a 4/12 pitch flush roof and then upgrade from there. Overhangs can be partially or fully vented if you'd like. Usually if you decide to add guttering at any time, it is recommended to have at least 1' Overhang for a solid area to mount guttering.

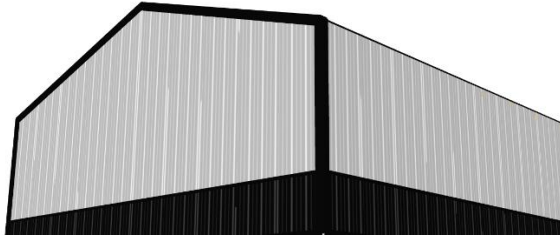

Flush Roof - No Overhang

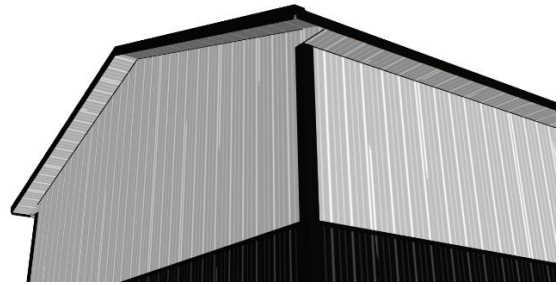

12", 16" or 24" overhang (vented or non-vented)

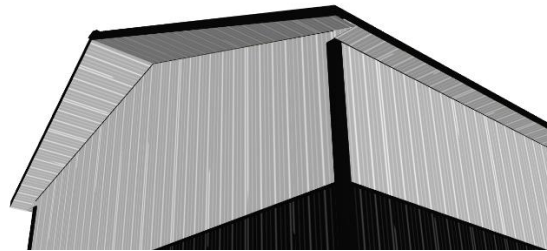

Flying Gable



Additional Eyebrows (up to 6" deep)

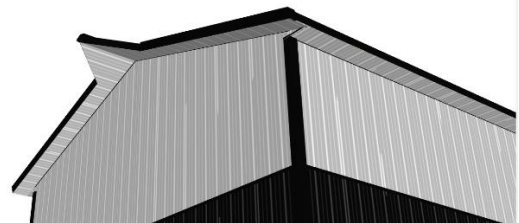

Barn Peak

GRABER POST BUILDING'S Truss Styles

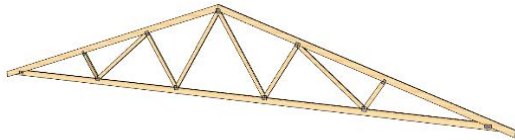

Standard Pitch

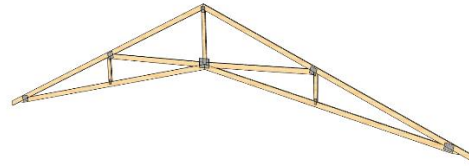

Scissor (cathedral style)

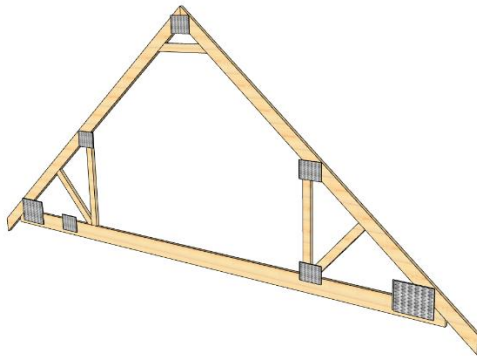

Room-in-Attic

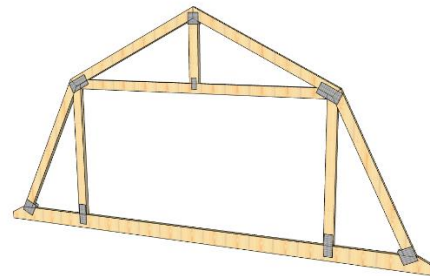

Gambrel (attic)

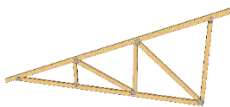

Mono (shed roof)

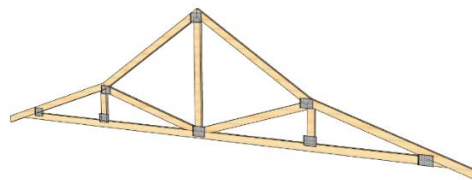

Western

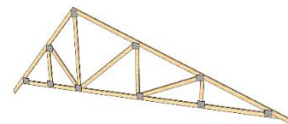

Dual Pitch

GRABER POST BUILDING'S Porch Designs

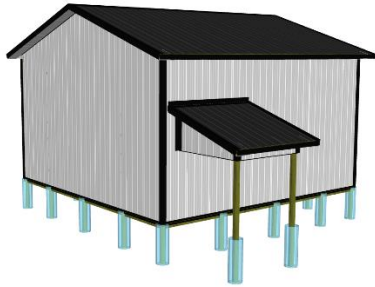

Open Lean-To Porch

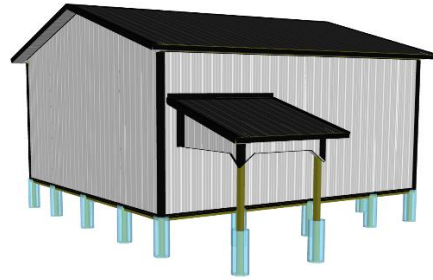

Open Lean-To Porch with upgraded V-Bracing

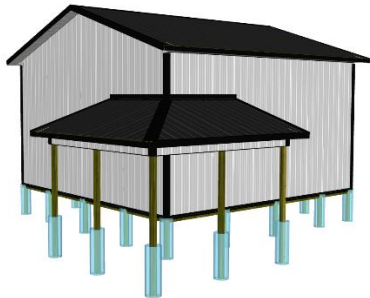

Open Wrap-Around Porch

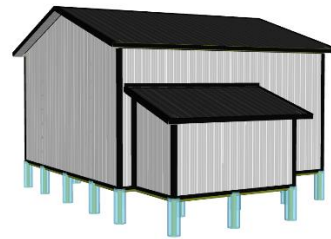

Enclosed Lean-To

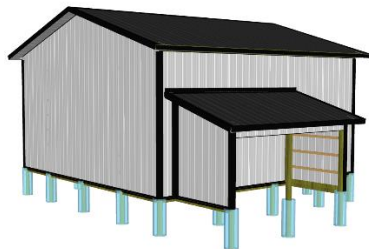

Lean-To with Eaves Open

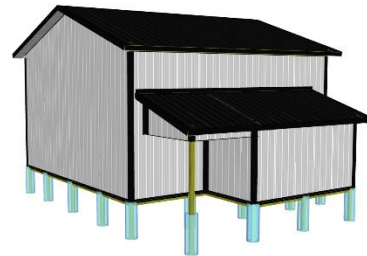

Enclosed Lean-To with Porch Area

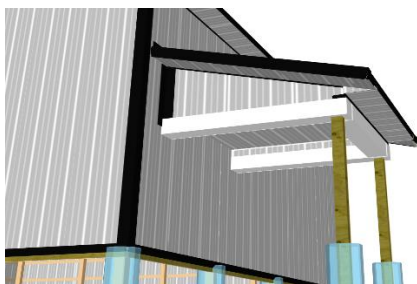

Porch with Treated Posts



Porch with Metal Post Wrap

GRABER POST BUILDING'S

Types Of Roofing

We install several different types of roofing on our projects but our G-Rib Profile 29 Ga. metal product, which has a 40 year paint warranty, is by far our most popular. Most of our pole barns, garages, and ag building have the G-rib or similar metal product due to the savings on install time, and framing procedures required with other products, that are not needed when using metal. It can also be installed very efficiently over existing worn out shingles or cases of storm damage.

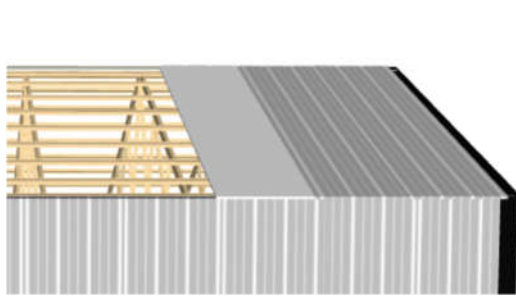

G-Rib or R-Rib over 4x8 EPS Foam
(exposed fastener)

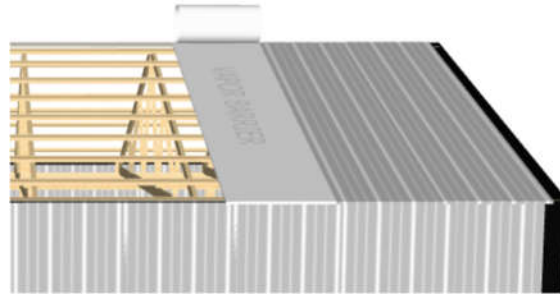

G-Rib or R-Rib over Roll Vapor Barrier
(exposed fastener)

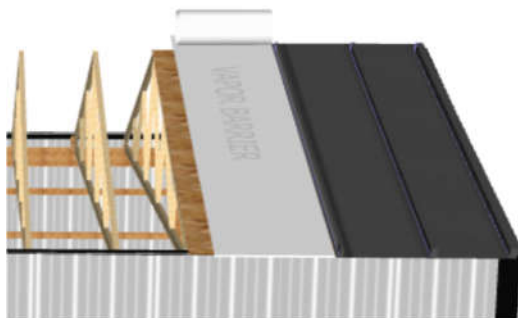

Standing Seam 16" or 12"
(hidden fastener)

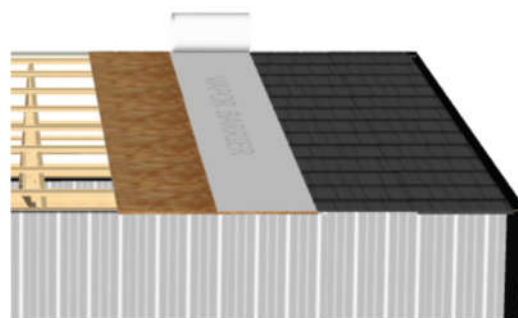

Metal Shingle from Boral
(hidden or exposed fasteners)



Asphalt Shingle from Owens Corning
(hidden fasteners)



G-Rib over Existing Asphalt
(exposed fastener)

RE-ROOFING

GRABER POST BUILDING'S Popular Siding Options

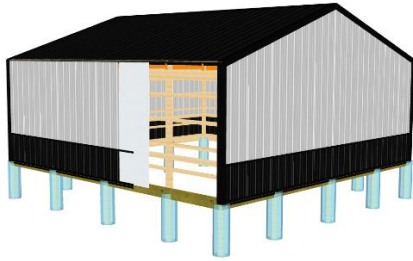

G-Rib or R-Rib with Wainscote



ALL NEW – Metal Board Batten



Versetta Stone Wainscote



Boral Nova-Brik Wainscote



K- Line Finished – LP 4x8 Strand



K- Line Finished – LP 8" Lap



Vinyl Siding From Provia



Rough Sawn Lumber – Unfinished

GRABER POST BUILDING'S Wall Framing Styles

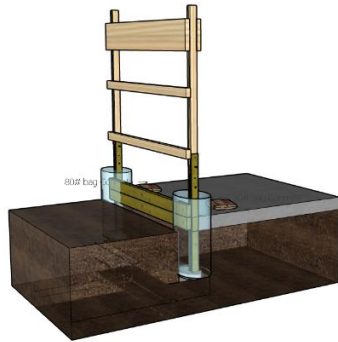

Standard Post Frame

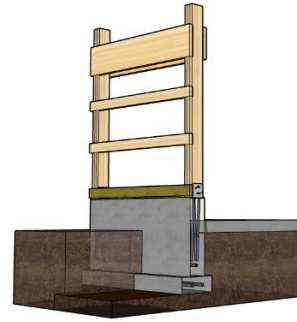

Sturdi-Wall Bracket - Post Frame

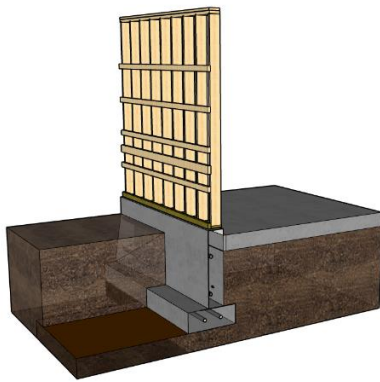

Stud Frame with Girts

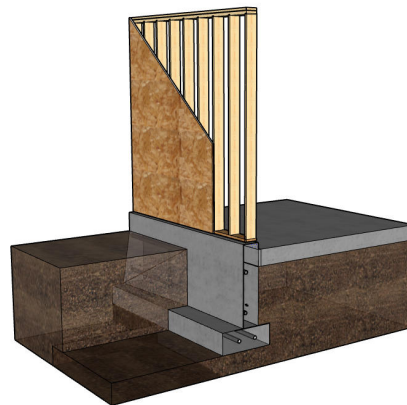

Stud Frame with Solid Sheathing

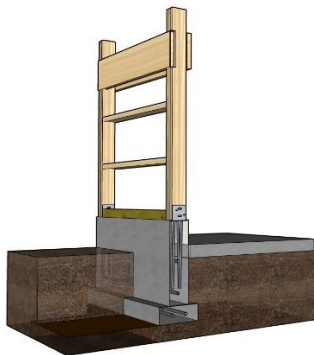

Sturdi-Wall - Post Frame - Bookshelf Girts

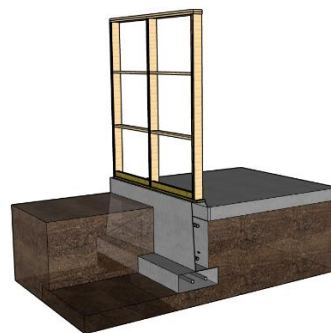

Bookshelf Framed

GRABER POST BUILDING'S

Post Frame Interior Finish Framing

If you plan to finish the interior of your barn and you will be using any of our post frame designs, or already have a barn and wish to finish it out, there are two popular techniques that can be used to do this.

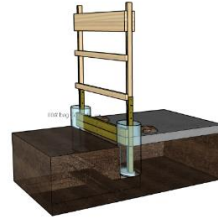

When using our G-Rib or similar metal liner, 2x4 Spruce girts are added to the inside of the wall with a treated 2x4 at the bottom row. These will be spaced at 2' intervals, which makes it very convenient to fasten 24" wide rolled Kraft Faced batts before installing the liner material.

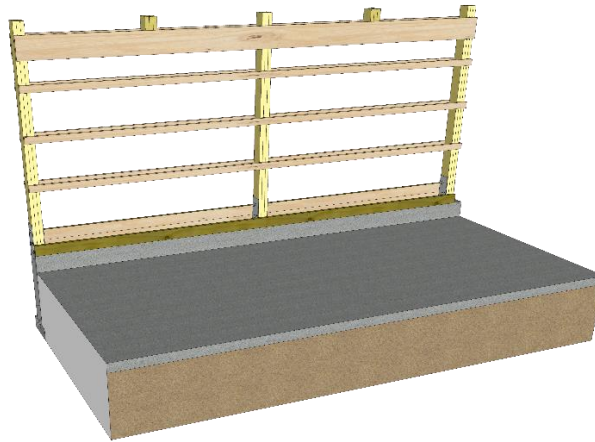

In cases where a 4x8 sheet liner product such as drywall or osb used, it makes more sense to use vertical studs between the posts at 16" or 24" spacings depending on which product is used. For drywall, 16" can be a better choice to prevent cracks in the finish. This method can be insulated in the same manner as stated above with batts.

